



Pro Series

Gas Powered Drivers

Tough tools for tough jobs. Rhino Pro Series line of drivers are designed for fencing, sign installation, agriculture, livestock, construction, landscape, utility and many other industries. Engineered for long tool life and backed up by Rhino Tool Company's Lifetime Impact Warranty.



Ranch Pro™

The Ranch Pro™ Gas Powered Driver is perfect for T-post and ground rod. Powerful yet light weight and ergonomic. Equipped with a 1-3/4 inch ID heavywall chuck the unit comes standard with a 1-inch adapter and locking clip.

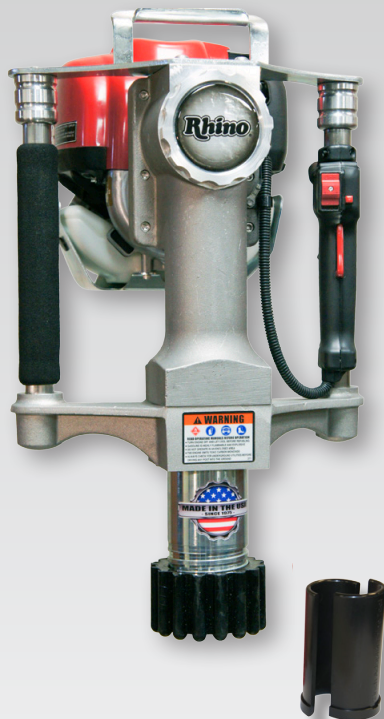

Fence Pro™

The Fence Pro™ Gas Powered Driver, the first choice of fence contractors, delivers more power to take on tougher jobs. Equipped with 2-1/2 inch ID chuck with Rhino® Chuck-Lok™ adapter system and 2-inch adapter. Optional 1-inch, and 1-3/4-inch adapters are available.

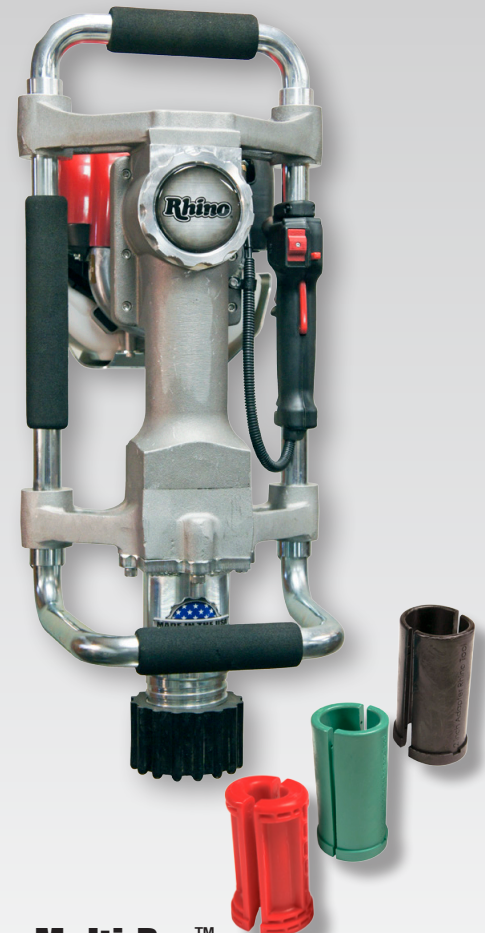

Multi-Pro™

The Multi-Pro™ Gas Powered Driver is ideal for rental, sign installation, tent stakes, grape stakes and many other applications. Interchangeable chuck design expands the range of driving profiles with optional chucks and driving accessories. Equipped standard with Rhino® Chuck-Lok™ adapter system and 1-, 1-3/4-, and 2-inch adapters.

POWERED by
HONDA™

*Driven To
Perfection!*



Covered by Rhino Tool Company's
Lifetime Impact Warranty.
Visit www.rhinotool.com for more details.

Rhino Tool Company, Inc.
620 Andrews Avenue
Kewanee, IL 61443
309-853-5555 or 866-7071808
www.rhinotool.com
info@rhinotool.com

Pro Series Gas Powered Drivers Specifications

*Driven To
Perfection!*

	RANCH PRO	FENCE PRO	MULTI-PRO	Notes
Overall Dimensions (width x depth x height)	13 x 14 x 20.5 (330 x 355 x 528)	13 x 14 x 21.5 (330 x 355 x 546)	10.75 x 17 x 26 (273 x 432 x 660)	In (mm)
Weight (w/o fuel)	33.5 lbs (15.2 kg)	36.5 (15.5)	44 (19.9)	lbs (kg)
Impacts Per Minute	1720	1720	1720	Approximate
Applications	Chuck, Adapter, or Accessory Required ◆ Standard ● Optional			
1/2–7/8" Dia. Rod/Pin/stake	◆ 1" Adapter 300155 w/Locking Pin	◆ 2-1/2" Chuck-Lok™ System ● 1" Adapter 300900	◆ 2-1/2" Chuck-Lok™ System ◆ 1" Adapter 300900	
1– 1-5/8" Dia. Round Post	◆ 1-3/4" Master Chuck	◆ 2-1/2" Master w/Chuck-Lok™ System ● 1-3/4" Adapter 300895	◆ 2-1/2" Chuck-Lok™ System ◆ 1-3/4" Adapter 300895	
1-3/4 – 1-7/8" Dia. Round Post		◆ 2-1/2" Chuck-Lok™ System ◆ 2" Adapter	◆ 2-1/2" Chuck-Lok™ System ◆ 2" Adapter	
2 – 2-3/8" Dia. Round Post		◆ 2-1/2" Chuck-Lok™ System	◆ 2-1/2" Chuck-Lok™ System	
T-Post	◆ 1-3/4" Master Chuck	● 1-3/4" Adapter or ◆ 2" Adapter 300902	◆ 1-3/4" Adapter or ◆ 2" Adapter 300902	
Tent Stake			● Multi-Pro Tent Stake Chuck 301155	NOT for use on pipe, solid stakes only, up to 2-5/8" head dia.
1.2 -4 lb/ft Channel Post			● Multi-Pro Channel Chuck 301159 ● Multi-Pro Channel Anvil 301169	Multit-Pro Channel Drive Kit 301175 (includes 301159, 301169)
Silt Fence			● Multi-Pro Channel Chuck 301159 ● Multi-Pro Channel Anvil 301169	Multit-Pro Channel Drive Kit 301175 (includes 301159, 301169)
1-3/4" Square Tupe			● Multi-Pro Short Chuck 301171 ● Multi-Pro 1-3/4" Drive Cap 300932	Multi-Pro Short Chuck 301171 is required with any Multi-Pro Drive Cap. Multi-Pro Municipality Kit 301185 (includes 301171, 300932,300933,300934,300935,301159,301169)
2" Square Tube			● Multi-Pro Short Chuck 301171 ● Multi-Pro 1-3/4" Drive Cap 300933	Multi-Pro Short Chuck 301171 is required with any Multi-Pro Drive Cap. Multi-Pro Municipality Kit 301185 (includes 301171, 300932,300933,300934,300935,301159,301169)
2-1/4" Square Tube			● Multi-Pro Short Chuck 301171 ● Multi-Pro 1-3/4" Drive Cap 300934	Multi-Pro Short Chuck 301171 is required with any Multi-Pro Drive Cap. Multi-Pro Municipality Kit 301185 (includes 301171, 300932,300933,300934,300935,301159,301169)
2-1/2" Square Tube			● Multi-Pro Short Chuck 301171 ● Multi-Pro 1-3/4" Drive Cap 300935	Multi-Pro Short Chuck 301171 is required with any Multi-Pro Drive Cap. Multi-Pro Municipality Kit 301185 (includes 301171, 300932,300933,300934,300935,301159,301169)

Engine Specifications	
Engine Configuration	4-stroke, 35.8 cc
Fuel	Unleaded Gas, 86 octane or higher
Fuel Capacity—US qt (ltr)	0.67 (0.63)
Engine Oil	SAE 10W-30

Your specific application not shown?

Use the method below to determine if your post will fit inside the round master chucks. Contact Rhino Tool Company for special application details

How to measure your post: Please note, chuck and chuck adapter sizes shown are actual inside dimensions of the opening. To select the proper adapter, **measure the longest outside dimension** of the post to be driven to confirm it will fit inside the opening. In the case of square or rectangular posts measure the longest diagonal from corner to corner.

Note: Custom chucks may be available for your specific application contact Rhino Tool Company.

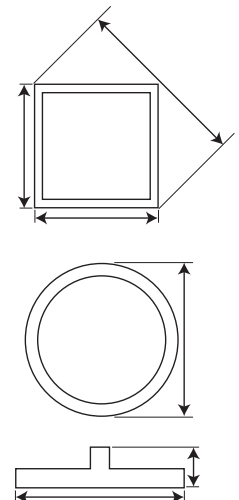

*Driven To
Perfection!*