

# 55 Pneumatic Post Driver

# QuickSTART

## OPERATING INSTRUCTIONS



Pneumatic • Hydraulic • Gasoline  
Professional Grade Tools

## IMPORTANT SAFETY PRECAUTIONS



**DANGER**

### UNDERGROUND UTILITIES:

Best practices are to contact utility or your municipality office to determine if area is safe to drive post. Driving a post into an underground utility can be **EXTREMELY DANGEROUS**, exposing the operator and those around to potentially life threatening danger. Ensure that a certified locating service has identified all underground utilities prior to beginning your project. (Electric, Gas, Telephone, Water, Sewer, TV Cable, Lawn Sprinklers, etc.)



**DANGER**

### AIR PRESSURE:

The use of the pressure regulator is required for safety. Set the pressure regulator at 90 PSI (6.2 bar). Higher air pressures will not make your driver perform better. Slowly squeeze the air throttle valve lever to start the driver. Opening the throttle valve slowly will prevent a violent start of the driver. Air pressure over 90 PSI (6.2 bar) may result in the driver jumping off the post and causing bodily harm.



**WARNING**

### AIR REQUIREMENTS:

**PD-45:** 30 CFM (0.85m<sup>3</sup>/min.) @ 90 PSI (6.2 bar)

**PD-55:** 42 CFM (1.19 m<sup>3</sup>/min.) @ 90 PSI (6.2 bar)



**WARNING**

### LUBRICATION: YOU MUST OIL YOUR POST DRIVER WHILE IT IS OPERATING:

If using an FRL, set the lubricator on your Filter-Regulator-Lubricator in the air line to the post driver so it will deliver approximately 10 drops of oil per minute. The procedure for lubricating the hose is as follows—Remove the air hose from your post driver and **AFTER SECURING THE AIR LINE SO IT CAN'T WHIP AROUND TO INJURE SOMEONE**, open the lubricator wide open so that a steady stream of oil runs into the air stream after the throttle valve has been activated. Actuate the air throttle valve and run the air through your hose (aimed at a piece of cardboard) until an oil film is seen coming out of the air hose. Periodically check to make sure your driver is receiving oil. Air and oil will be exhausted through the chuck. If in doubt, remove the air line to see if an oil film is being exhausted from the hose end that connects to the driver. If oil is coming out of the hose, reconnect the air hose to the driver.



**WARNING**

**HEARING PROTECTION IS REQUIRED** as the post driver emits noise over 100 dB level. Operator and bystanders should wear proper PPE (hearing, eye, head and foot protection) during power tool operation. Check surroundings at all times and remove children, animals, and unauthorized persons from the area to prevent possible injury.

*Please refer to the Owner's Manual for this tool or contact a Rhino Service Tech, for additional support, at 866-707-1808.*

## INSPECT

Visually inspect your post driver before use. The interior of the chuck tube should be checked for obstructions or damage to the chuck tube. The outer surfaces of the driver should also be inspected for any defects. Check air-lines for any abnormalities such as bulges, wear spots or tears and replace if necessary.

## CLEAN & LUBRICATE

1. Blow out air lines before coupling them to your post driver. This precaution will help remove any dirt that may have entered an open hose. **DO NOT** turn on pressurized air through an unsecured air line; the air line could whip around causing serious injury.
2. Use SAE 5 wt. Oil in cold weather, SAE 10 wt. Oil for mild weather to 80°C (27°F) and SAE 20 wt. Oil for hot weather.  
We recommend non-detergent oil to prevent degradation of the air hose. Do not use synthetic oil as it impedes atomization of the oil in the air stream.

## START-UP

- Set lubricator to deliver 10 drops of oil per min
- Secure the air line
- Make sure the regulator is set at no more than 90 PSI (6.2 bar)
- Slowly squeeze the air throttle valve lever to start the driver.
- Make sure a steady stream of oil is coming from the lubricator.

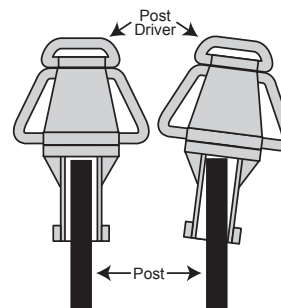

**RIGHT      WRONG**

Proper alignment of driver and post is important.

- Do not use a chuck or chuck adapter that is too large for the post being driven.
- Place the driver on the post to be driven.
- Properly align the post.

*continued on back*

# SERVICE INSTRUCTIONS

## EACH USE:

1. Drain the water from the air compressor reservoir.
2. Ensure the air pressure setting on the FRL is correct.

**PD-45:** 30 CFM (0.85m<sup>3</sup>/min.) @ 90 PSI (6.2 bar)

**PD-55:** 42 CFM (1.19 m<sup>3</sup>/min.) @ 90 PSI (6.2 bar)

3. Check the oil level on the FRL and fill when needed.

## ROUTINELY:

1. Drain the filter stage of the FRL regularly, especially in winter. Clean the air filter element as needed.
2. When storing the post driver for prolonged period, add extra oil into the air inlet of the post driver. Slowly roll the driver over to allow the oil to coat all inside surfaces, then stand the driver upright, allow any condensation to drain.

## CONNECTING A PD-55 TO A FILTER-REGULATOR-LUBRICATOR (FRL) AND COMPRESSOR

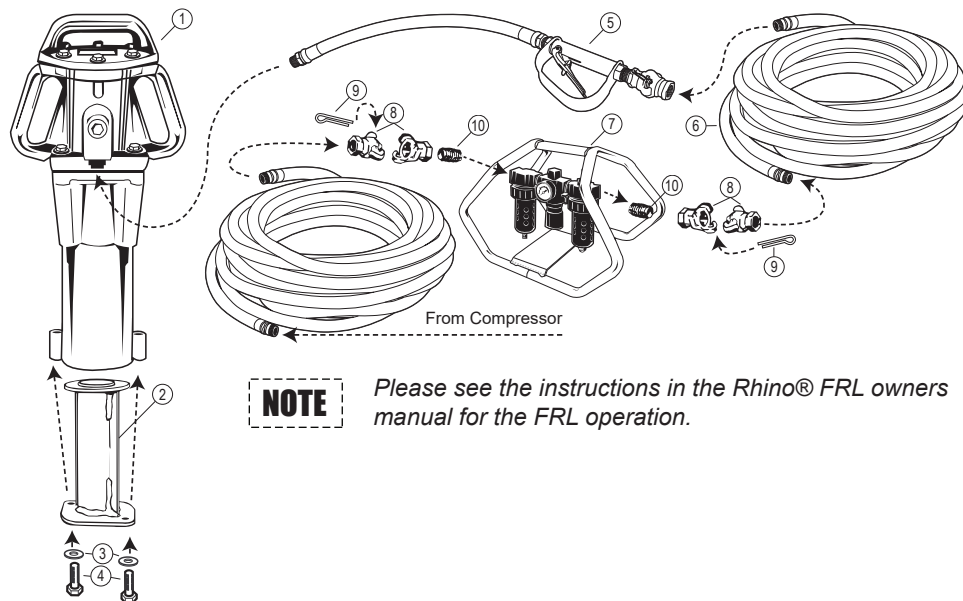

| No. | Part No | DESCRIPTION   |
|-----|---------|---|
| 1   | 070013  | PD-55 Post Driver w/3" (76.2) Chuck                           |
| 2   | 070609  | 3-1/2" (89) Chuck Adapter (See Chart 1 for addtl. options)*** |
| 3   | 517702  | Compression Washers (See Fig. 5)***                           |
| 4   | 500007  | Cap Screws (See Fig. 6)***                                    |
| 5   | 600000  | Throttle Valve Kit  |
| 6   | 607000  | Hose Assembly*  |
| 7   | 225005  | Filter-Regulator-Lubricator (FRL) & Carrier                   |
| 8   | 606000  | Air Line Coupler**  |
| 9   | 606601  | Coupler Safety Clip   |
| 10  | 230041  | Nipple**  |

\* Order to desired length

\*\* Optional on FRL

\*\*\* Optional - includes items 3 and 4

**CHART 1:** Master Chuck and Chuck Adapter sizes and part numbers. Select the proper Chuck I.D. or shape then order the part number under your post driver's model number.

| MASTER CHUCKS          |                   |                 |                 |
|------------------------|-------------------|-----------------|-----------------|
| Chuck Size inches (mm) | Chuck Description | PD-55 Chuck P/N | PD-45 Chuck P/N |
| 3 7/8 (98.4)           | Master Chuck      | 70592           | NA              |
| 3 (76.2)               | Master Chuck      | NA              | 70591           |

| MASTER CHUCK ADAPTERS      |                     |                   |                   |
|----------------------------|---------------------|-------------------|-------------------|
| Adapter Size inches (mm)   | Adapter Description | PD-55 Adapter P/N | PD-45 Adapter P/N |
| 3 1/2 (88.9)               | Round Post Adapter  | 70609             | NA                |
| 3 (76.2)                   | Round Post Adapter  | 70610             | NA                |
| 2-1/2 (63.5)               | Round Post Adapter  | 70611             | 70600             |
| 2 (50.8)                   | Round Post Adapter  | 70612             | 70601             |
| 1-1/2 (38.1)               | Round Post Adapter  | 70613             | 70602             |
| 1 (25.4) Adapter           | Round Post Adapter  | 70614             | 70603             |
| 2 (50.8)                   | T-Post              | 70615             | 70871             |
| 1.2 to 1.5 lb Channel Post |                     | 70617             | 70606             |
| 2 to 2.75 lb Channel Post  |                     | 70618             | NA                |
| 3 to 4 lb Channel Post     |                     | 70619             | NA                |

## **WARNING** CHUCK SIZING

**A chuck or Chuck Adapter that is too large for the post being driven may contribute to a condition which would allow the post driver to fall or jump from the post causing serious injury or death!**

Please note, Chuck and Chuck Adapter sizes shown (**Chart 1**) are actual inside dimensions of the opening. To select the proper Adapter, measure the longest outside dimension of the post to confirm it will fit inside the opening. In the case of square or rectangular posts measure the longest diagonal from corner to corner.

SCAN QR CODE FOR OPERATING MANUAL AT RHINOTOOL.COM



A Tradition of Quality and Service Since 1975

Visit [rhinotool.com/service](http://rhinotool.com/service) for more information

